

DANA collection

Ambient lighting



Square and rectangular mirrors with an extruded aluminum frame and integrated LED. Ideal for bathrooms, halls, hallways... Spaces where you can create an environment with personality.

Espejos cuadrados y rectangulares con marco de extrusión de aluminio con LED integrado para ofrecer una iluminación indirecta. Ideal para baños, recibidores, zonas de paso... Espacios donde poder crear un ambiente con personalidad.



SPEHO

ILLUMINATED MIRRORS

DANA collection

Ambient lighting

SPEHO
ILLUMINATED MIRRORS



Specifications Especificaciones

Click install System
Sistema Qlick install

Lighting System led strip 120leds/m
Sistema de iluminación tira de led 120leds/m

Power 220-240V
Potencia 220-240V

(Optional 110V)
(Opcional 110V)

Color temperature 3000K
Temperatura de color 3000K

| 4000K | 5700K
| 4000K | 5700K

Decorative frame: aluminum
Marco decorativo de aluminio

Glass 4 mm
Luna de 4 mm

 2 Positions
2 Posiciones

Extra Extras

 Glow led strip.
Tira led Glow.

 Laser or backlit logo.
Logo láser o retroiluminado.

 Defogger.
Antivaho.

 Adjustable intensity.
Intensidad regulable.

 Touch sensor.
Sensor táctil.

 Adjustable color temperature
Temperatura de color regulable

Standard sizes (mm) Dimensiones estándares (mm)

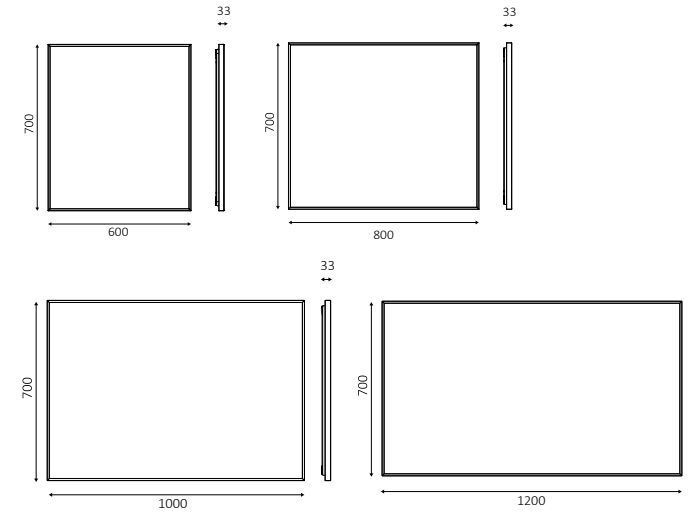

Please consult us for special sizes.
Consultar para medidas especiales.

Profile section Sección del perfil

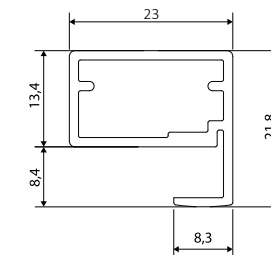

Acabados Finishing options

 Matt black
Negro mate

*Other decorations
available on demand
*Otros acabados
disponibles

